

STANDARD Q RSV Ag

STANDARD Q RSV Ag Test is a rapid chromatographic immunoassay for the qualitative detection of RSV antigen present in nasopharyngeal secretion from patients with symptoms of a viral respiratory infection. This test is for in vitro professional diagnostic use and intended as an aid to early diagnosis of RSV infection. It provides only an initial screening test result. Specific alternative diagnosis method should be performed in order to obtain the confirmation of RSV infection.

GENERAL INFORMATION:

- Getting a fast result in 15 minutes
- Easy handling which does not require specific training
- Suitable for Point Of Care Testing
- No follow-ups or equipments required
- External quality controls provided



Specification	
Intended Use	Detection of Syncytial Virus (RSV) antigens
Test Time	15mins (Do not read after 30 minutes)
Specimen Type	Nasopharyngeal Swab / Nasopharyngeal wash/aspirate
Storage Temperature	2-40°C / 36-104°F

TEST PROCEDURE

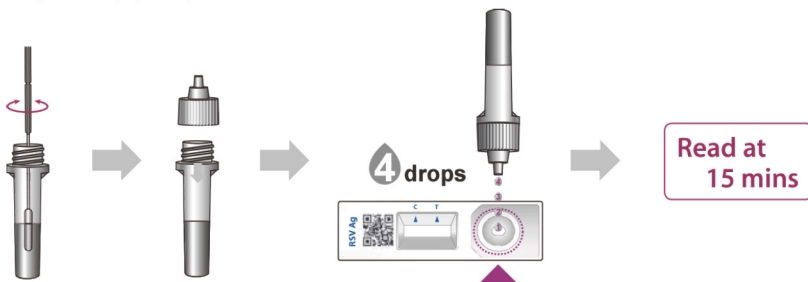

INTERPRETATION

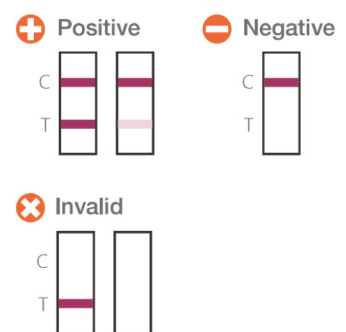

TEST PERFORMANCE

Reference	Sensitivity	Specificity
PCR	92.45% (49/53)	98.44% (126/128)

ORDERING INFORMATION

Category	Product	Pack Size
Respiratory Disease	STANDARD Q RSV Ag Test	25 Test
	STANDARD Q RSV Ag Control	Pos x 10 / Neg x 10